



2023 Cranberry Fest

Eagle River, WI

800-359-6315

events@eagleriver.org

Saturday, October 7, 2023 & Sunday, October 8, 2023

9am - 4pm

9am - 3pm

The 43rd Annual Cranberry Fest Exhibitors Committee invites you to apply for participation in our juried 2023 Cranberry Fest Arts & Crafts Exhibition.

Booth Information (per 10 x 10 space):

\$350 10' x 10' inside craft tent

\$350 10' x 10' inside craft barn

\$350 10' x 10' inside exhibit building

\$300 10' x 10' outside space/fairgrounds

\$ 75 Electricity

\$ 50 Early Set up (Friday 8am - 11am)

Booth spaces are non-transferable. Security will be available to cover festival grounds; however, we are not responsible for merchandise left in booths. Booth layout and booth assignments will be determined by the committee and we will honor requests when able. **If requesting a particular booth space, please see enclosed map to determine your requested spot.** Electricity will be available in the craft barn, fairgrounds exhibit building, craft tent and a few outside locations along the craft tent and exhibit building. If possible, we will make this service available. If impossible, we will return your \$75 check for electricity.

Event Set Up: Friday, October 6, 2023 (12:00pm - 6:30pm) or Saturday, October 7, 2023 (6:00am - 8:00am).

All vendors must check in at the vendor check in. Early set up will be available on Friday for an additional fee of \$50. Early set up time will be 8am - 11am. **All set up on Friday ends at 6:30pm.** Your booth must be set up by 8:00am on Saturday. If you set up in the wrong space you will have to tear down and move to your assigned spot. Absolutely no driving will be allowed on the grass without permission. Be prepared to cart your items into the booth area from vendor parking. **Vendors must park in the vendor parking areas.** Please be courteous to your fellow vendors when considering where you are parking. **No parking allowed by craft vendors on Forest St. or in the front parking lot of the fairgrounds on Hwy 70.**

Rules:

In order to maintain our high standards for exhibitors, we require all work to be your own original art or handcrafted items. No wholesale (buy-sell items), flea market, imported or machine screen printed items will be accepted. All work exhibited is expected to be equivalent in quality to that depicted in the application photographs. All exhibitors must set-up and exhibit through Sunday, October 8th at 3pm, rain or shine. Exhibitors who do not comply with these rules will be required to remove their work immediately without refund of fees and may be required to tear down and leave festival grounds; and will not be invited back. The decision of the committee is final. **The deadline for application is March 1, 2023 or until all booths are full.** No decision will be made until after the deadline of March 1st and please allow at least 2 - 4 weeks for jurying.

Permits/Liability Insurance Information:

- All exhibitors are required to have **their Wisconsin Seller's Permit number on file with our office** in order to participate. You may obtain one by contacting the Wisconsin Dept. of Revenue, Income, Sales Inheritance & Excise Tax Division, P.O. Box 892, Madison, WI 53708 or call (608) 266-2776.
- All exhibitors are required to have a **valid certificate of General Liability Insurance during the show on file with our office** in order to participate.

Cancellation Policy:

Fees must be included with the application form and are non-refundable after notification of selection unless the space can be reassigned to another vendor. In this case, there will be a 20% cancellation fee withheld from your refund. **There are NO REFUNDS for cancellations within ONE MONTH PRIOR to the event.**

2023 Cranberry Fest Vendor Booth Layout



NORTH

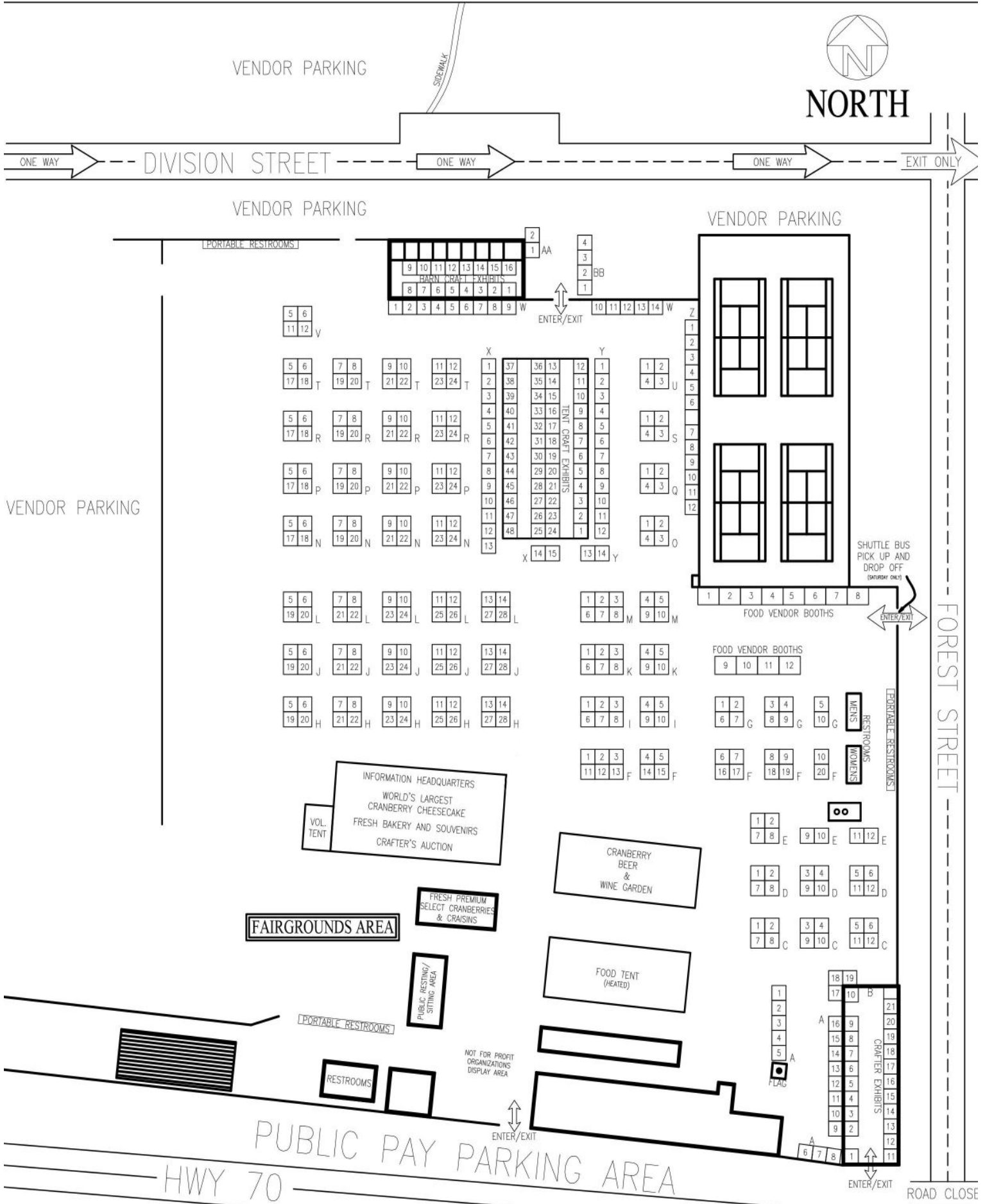

VENDOR PARKING

VENDOR PARKING

VENDOR PARKING

VENDOR PARKING

DIVISION STREET

FOREST STREET

HWY 70

PUBLIC PAY PARKING AREA

ROAD CLOSE



Cranberry Fest Arts & Crafts Show

October 7 - 8, 2023

Vilas County Fairground
9am - 4pm and 9am - 3pm
800-359-6315

events@eagleriver.org

OFFICE USE ONLY

Payment Form: _____

Amt Paid: _____

Post Mark Date: _____

Cert. of Insurance: _____

Booth Assignment: _____

Submit to: EAGLE RIVER AREA CHAMBERER OF COMMERCE
P.O. Box 1917 – CF
Eagle River, WI 54521

Business Name: _____

Exhibitor Name: _____

Address: _____

City/State/Zip: _____

Telephone: _____ Cell Phone: _____

Website: _____ E-Mail: _____

Method of Payment (Please make payable to the Eagle River Chamber of Commerce):

- Check
- Money Order
- Credit Card

Credit Card Number: _____ Expiration Date: _____ CVC#: _____

Signature: _____ Date: _____ Zip Code: _____

Print Name Listed on Credit Card: _____

My booth preference is: (Mark 1st, 2nd, & 3rd choice)

_____	Would like to have my past booth space(s). List preferred location from enclosed map.	_____
_____	Inside craft tent 10' x 10'	\$ 350
_____	Inside craft barn 10' x 10'	\$ 350
_____	Inside fairgrounds exhibit building 10' x 10'	\$ 350
_____	Outside space/ fairgrounds area 10' x 10'	\$ 300
_____	I will need electrical hook-up	\$ 75
_____	* Early Set Up: 8am - 11am on Friday, October 6	\$ 50

*Gate for Early Set-Up will open at 8am and close at 11am. All other set-up will start at Noon.

Total Remitted \$ _____

Categories for Jurying: (PLEASE CIRCLE ONLY ONE)

Basketry Candles Ceramic Clothing Fine Art Floral Food Product Furniture Holiday Jewelry
 Metal Music Painting Photography Pottery Sewn Soaps Stained Glass Textiles Wooden
 Miscellaneous (One word that best describes what you are selling): _____

Description of Art/Craft: (This will be used for your listing in the Cranberry Crier): _____

IN ORDER FOR YOUR WORK TO BE CONSIDERED FOR EXHIBITION YOU MUST SUBMIT THE FOLLOWING:

- 1) This *completed and signed* Application and Seller's Permit Form (side one and two of this sheet).
- 2) A certificate of General Liability Insurance valid during the time of the show, must be on file with our office in order to participate.
- 3) Your booth payment in the form of check(s), credit card information or money order(s). Please make checks payable to the Eagle River Area Chamber of Commerce. If your work is not selected all fees will be returned to you.
- 4) Five color photographs of your work for jurying. One photo must be of your display booth, one must show you working on your project and three must be of the items you will be selling at the event. Photos must be labeled with your name and a short description of the items being sold. **All work exhibited is expected to be equivalent in quality to that depicted in the application photographs.**
We will return your photos to you. Photos can be emailed to: events@eagleriver.org

I accept the rules and regulations regarding my participation in the 2023 Cranberry Fest Arts & Crafts Show. I understand that all work exhibited has to be my very own original art or handcrafted items.

Signature: _____ Date: _____

Seller's Permit Form
2023 Cranberry Fest Arts & Crafts Show
October 7 - 8, 2023

Return to: Eagle River Area Chamber of Commerce
PO Box 1917 - CF
Eagle River, WI 54521

Wisconsin law (sec. 73.03(38), Wis. stats.) requires that each operator of a swap meet, flea market, craft fair or similar event must report to the Wisconsin Department of Revenue the name, address, social security number and the Wisconsin seller's permit number (if available) of each vendor selling merchandise at the event.

THIS FORM MUST BE COMPLETED AND RETURNED WITH YOUR APPLICATION

1. Name of Operator or Sponsoring Organization: Eagle River Area Chamber of Commerce
2. Name of Event: Cranberry Fest Arts & Crafts Show
3. Date(s) of Event: October 7 and October 8, 2023
4. Location of Event (City or Town): Eagle River, Wisconsin
5. Vendor/Seller's Real Name: _____
6. Business Name: _____
7. Address: _____
8. City, State, and Zip Code: _____
9. Social Security Number (**Required** - Last Four Digits): _____
10. Wisconsin Seller's Permit Number: _____

Indicate below the type(s) of activity you intend to engage in at this event.

11. **Selling Merchandise** - Includes the sale, rental, lease, exchange, trade or taking orders of any merchandise goods, or products for money and/or other consideration. Describe the type of product. _____

12. **Selling a Service** - Includes the sale, rental, lease, exchange or trade of any service or admission or money and/or other condition. Describe the type of service or admission. _____

